

Zoo Field Landscape Design Consultation

Following a public consultation in May-June 2021, a landscape design has been developed for Zoo Field through Central Park's Treescape for the Future project, part of the [Green Minds](#) programme.

The design has been created by a group that includes community members, Plymouth College of Art students, volunteers and Plymouth City Council apprentices and is led by a local permaculture teacher from Food Plymouth. The group have spent time getting to know all about Zoo Field and have created a design that responds to the field and consultation comments, which you can see below.

We would love to hear your feedback and comments on the design, which you can submit [here](#). The consultation closes on Sunday 31st October.

We plan to start work in Zoo Field this winter. If you would like to get involved in activities and help care for this part of the park, you can sign up to the [Green Minds](#) mailing list here.

Informal areas under trees

- ⤿ Open up views under tree canopy
- Informal space for play, exploration, outdoor classroom
- 🌻 Wildflower planting

Old zoo entrance

- ⬠ Welcome sign with information about nature/history
- 🌻 New mown path to explore
- 🌻 Edible planting

Zoo trail

- Open your eyes
- Observe nature

Feel the wind on my face
I'm a part of the natural world
Enchanted by the trees
Listening to the birds
Discovering the magic of zoo field

Example poem for new sign

Lion's Den

- 📖 Log story telling chair
- ⦿ Keep the circle cut back
- 🌻 Edible planting
- ⬠ Welcome sign



Concept for story telling circle

Tree half circle

- ⬠ Log benches for rest and views. Daffodils, snowdrops and bluebells planted nearby
- 🌳 New trees will add to the half circle
- Improved access between the trees



The Half-tree Circle (from Below)

Concept for area

Orchard extension & east entrance

- ⬠ Make entrance more open and welcoming
- 🌳 Plant 2 cherry trees to frame entrance
- ⬠ Plant more fruit trees



Concept for cherry trees framing the entrance

Creating a design for Zoo Field

The design group have learned how to develop a landscape design that responds to nature, following expert guidance by Food Plymouth. This educational opportunity was set up by the Green Minds programme.

The design group spent time in Zoo Field, where they have been discovering the plants, wildlife and history of the site and getting to know the different areas of the field. The design they have created aims to improve the field for nature and people based on consultation feedback, while responding to the heritage and natural environment of the site:

- Keep the open greenspace, natural character and mature trees.
- Keep the existing walking routes and sense of peace and quiet.
- Keep areas for wildlife and find areas that can be improved for wildlife.
- Add more trees and wildflowers.
- Add more edible plants that can be harvested by the local community and provide food for wildlife. Include local and heritage varieties of fruit trees.
- Create a more welcoming community space, which invites play and exploration of different areas.
- Add more seating.
- Add signage about heritage and nature in the field.
- Be low maintenance and make use of resource from the park.



Using A-frames to measure contours

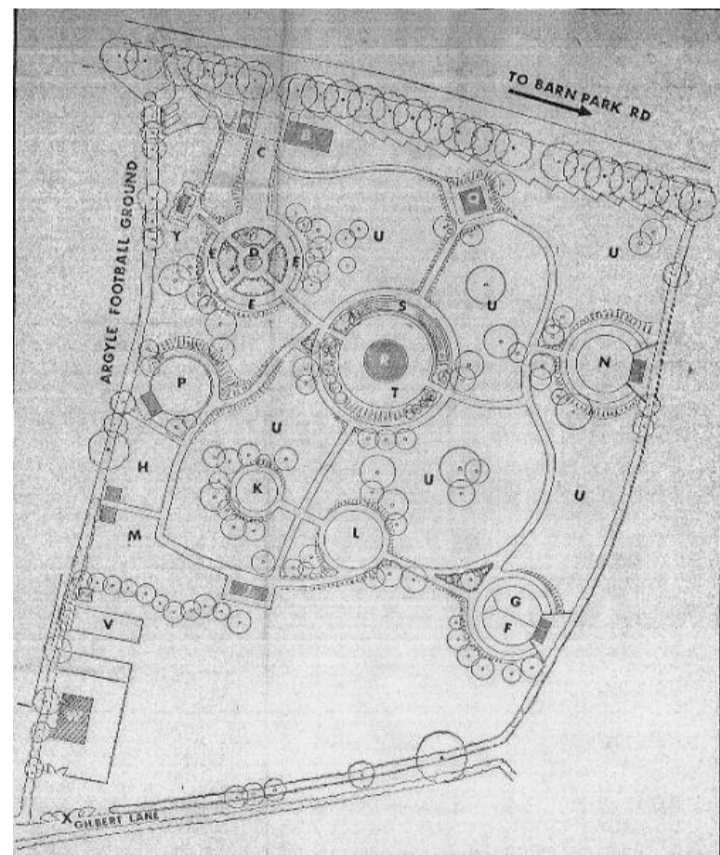

The zoo layout

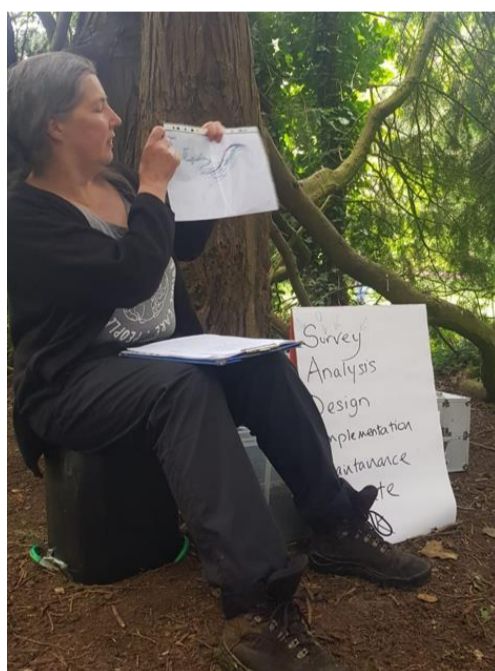

Learning about the design process; the tree cover made for an excellent outdoor classroom